

## **STEP 1 – Log into Google Chrome**

- All students will be signing up with for khanacademy using their **district login**.
- Make sure you are logging into to **Google Chrome**, **NOT Gmail**. (If you are getting an error message, make sure you are not trying to login into gmail.)
- To do this ... log into Chrome using your district login in the format:

firstname.lastname@students.christina.k12.de.us

Sample: [tyler.jones@students.christina.k12.de.us](mailto:tyler.jones@students.christina.k12.de.us)

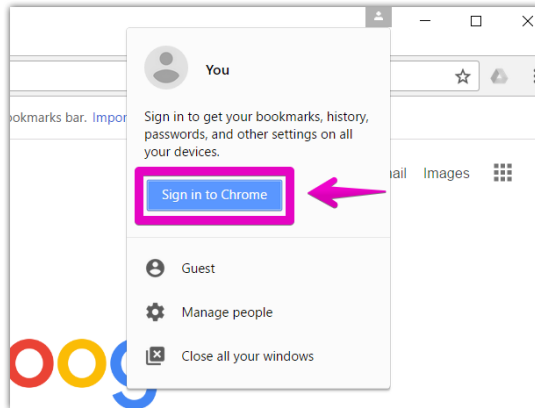

- Your **password** should be the same password that you have used to access any district computer from the previous school year.
- If you have any problems, please email me at christina.hanna@christina.k12.de.us

## **STEP 2 – Create your Khan Academy Account**

- 2a.) After you have logged into Google Chrome, go to KhanAcademy.org and click “sign up”

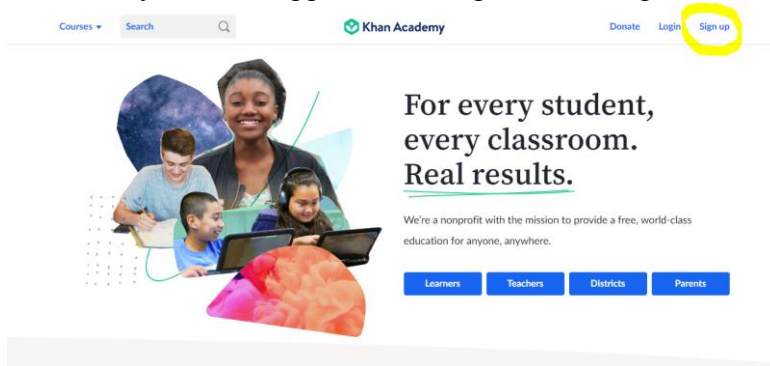

- 2b.) Select “**Learner**” and use the drop down menus to select your date of birth.

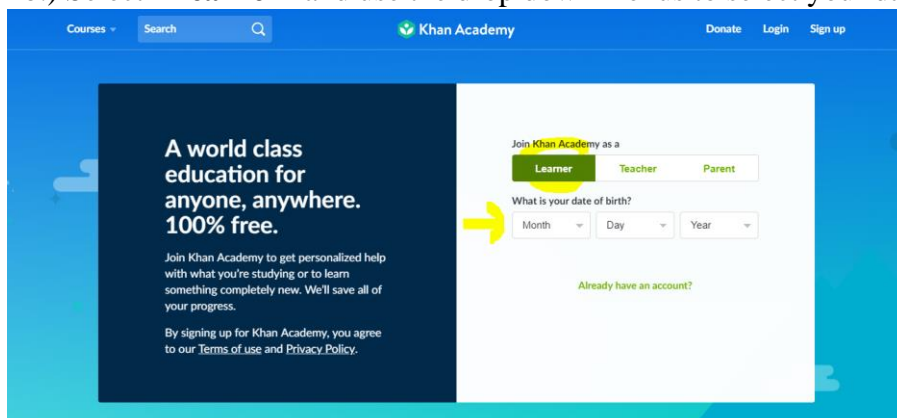

- 2c.) Select “Continue with Google” (this may take a few seconds)

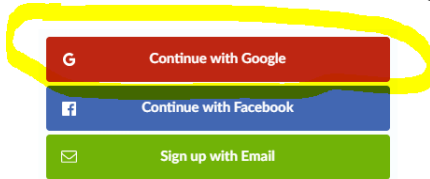

- If a screen pops up like the one below, select allow (this may take a few seconds)

Please select an account that you would like to use.

first.last @christina.k12.de.us  
 personal@gmail.com

Google is not affiliated with the contents of the application or its owners. If you sign in, Google will share your email address with the application but not your password or any other personal information.

[Sign in to another account](#)

Remember this approval for the next 30 days

- Answer the next few questions regarding your grade and math class
  - Select “9<sup>th</sup> Grade” on the first screen
  - Select “Mathematics I,” “Mathematics II,” and “Mathematics III” on the next screen

Math See all (32)

<input type="checkbox"/> Pre-algebra	<input type="checkbox"/> Algebra I	<input type="checkbox"/> High school geometry
<input type="checkbox"/> Algebra II	<input type="checkbox"/> Trigonometry	<input type="checkbox"/> High school statistics
<input type="checkbox"/> AP® Statistics	<input type="checkbox"/> Precalculus	<input type="checkbox"/> Differential Calculus
<input type="checkbox"/> Integral Calculus	<input type="checkbox"/> AP® Calculus AB	<input type="checkbox"/> AP® Calculus BC
<input checked="" type="checkbox"/> Mathematics I	<input checked="" type="checkbox"/> Mathematics II	<input checked="" type="checkbox"/> Mathematics III

Science See all (12)

<input type="checkbox"/> Physics	<input type="checkbox"/> AP® Physics 1	<input type="checkbox"/> AP® Physics 2
<input type="checkbox"/> Chemistry	<input type="checkbox"/> AP® Chemistry	<input type="checkbox"/> Biology
<input type="checkbox"/> High school biology	<input type="checkbox"/> AP® Biology	

Economics and finance See all (5)

<input type="checkbox"/> AP® Macroeconomics	<input type="checkbox"/> Macroeconomics	<input type="checkbox"/> AP® Microeconomics
<input type="checkbox"/> Microeconomics		

Back Step 2 of 2 ●● Continue with 3 courses

### **STEP 3 – Join the 9<sup>th</sup> Grade HSHA Section \*\*Please join by July 1<sup>st</sup>!**

- On the next screen, click on the “Coaches” tab on the dashboard in the top bar.

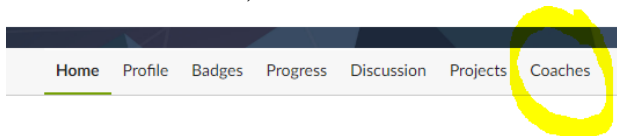

- Enter the following code in the box to join a class. Only join your specific class.
  - IM2/IM3 → **FW5734EE**
  - IM 3 → **XDVEN6TY**.
- After entering the join code, Christina Hanna will be listed under “Coaches”
- When you join the class, a request will be sent to Miss Hanna to approve you as a student. **If you join after July 1<sup>st</sup> and have not been added within 48 hours, please send me an email.**

- When your membership is approved, you will get a notification bubble next to your name, and there will be an “Assignments” tab on the dashboard.

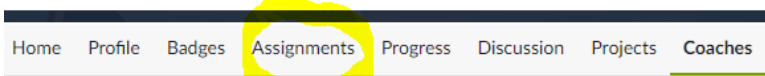

#### **STEP 4 – Accessing the Assignment**

- Click on the “Assignments” tab.
- Work on the assignments in order, making sure to complete all exercises and quizzes.
- You may want to watch the videos if you are struggling on a specific topic.

#### **TIPS FOR SUCCESS!**

- ✓ Start as soon as possible! Work on a little bit each day
- ✓ Don’t let the “**amount**” of assignments **intimidate** you; **most of these assignments are 2 – 4 problems each.**
- ✓ If you need help or get stuck... in each of the exercises there are opportunities to watch videos for extra help or to receive a hint.
- ✓ You may redo exercises if you want to improve your grade.
- ✓ ... Don’t wait till Labor Day! But seriously, don’t wait till the end of summer – do a little each week!

**\*\*If you join the course after July 1<sup>st</sup> and have not been added within 48 hours, please send me an email.**

If you have any questions please email Miss Hanna at [christina.hanna@christina.k12.de.us](mailto:christina.hanna@christina.k12.de.us)